



Contact: Peter Frey / (818) 906-6997

StarMazdaPR@aol.com



HOT ON THE HEELS OF A 3-RACE 'ROAD TRIP' – WITH ALL THREE RACES WON THE BY THE SAME DRIVER -- THE STAR MAZDA CHAMPIONSHIP PRESENTED BY GOODYEAR HEADS FOR ROUNDS 9 & 10 AT NEW JERSEY MOTORSPORTS PARK IN A HEATED BATTLE FOR THE CHAMPIONSHIP

Heading into the home stretch of the 2008 season, the Star Mazda Championship presented by Goodyear is embroiled in a heated battle for the championship – just three points separate the top-3 drivers... and the top-10 are all within striking distance.

Irishman Peter Dempsey completed a 'Canadian hat trick,' winning Round 8 of the Star Mazda Championship presented by Goodyear at the Mobli1 Grand Prix of Mosport. Dempsey, driving the #21 Andersen Racing / LotusWorks/ Allied Building Products Mazda, also won the previous events at Trois Rivieres and Road America, becoming the first driver this season to win three races. Ron White, in 2006, was the last Star Mazda Championship driver to win three in a row.

Finishing second at Mosport was Joel Miller in the #20 JDC Motorsports / Mazda / K&N Air Filters Mazda, followed by Tom Gladdis in the #5 Andersen Racing / Marrache & Co. / Allied Building Products Mazda. The Expert Series winner was Chris Cumming, driver of the #16 World Speed Motorsports / Inviro Medical Mazda, while the Gerry Kraut, driving the #55 JDC Motorsports / Dougherty & Co. / Dougherty Funding LLC Mazda, won the Master Series class.

Rounding out the top-5 were pole-sitter John Edwards, who's #7 AIM Autosport Mazda seemed to have the measure of the field, but got caught out of position by the long final yellow, and Alex Ardoin, in a strong comeback after a massive shunt in qualifying destroyed his #51 Mundill Racing / Oral & Facial Surgery Center / Twister Trailer Mazda, forcing him to start in the team's backup car.

Heading into a double-header at the brand-new New Jersey Motorsports Park – rounds 9 & 10 of the 2008 Star Mazda Championship presented by Goodyear -- Joel Miller has re-acquired the lead in the championship – by the slimmest of margins -- with 274 points. Peter Dempsey is in

second with 273, followed by Alex Ardoin with 271, Charles Hall with 262, John Edwards with 252 and Tom Gladdis in 6th with 247 points.

On-track action at NJMP begins with a 'promoter test day' on Friday, September 12. There will be two official practice sessions on Saturday morning, September 13, with qualifying for Race 1 taking place from 1:00 pm to 1:45 pm Saturday afternoon. Teams and drivers will have less than two hours to make any final adjustments to the cars before the green flag waves for the first race at 3:30 pm Saturday afternoon. The Sunday schedule is slightly more benevolent, with the 45-minute qualifying session taking place from 9:20 am to 10:05 am and the race scheduled to start at 2:15 pm Sunday, September 14.

Race 1 / Round 9 will air on SPEED TV Sunday, October 5 at 2:00 pm (ET), while Race 2 / Round 10 will be broadcast Sunday, October 12 at 1:00 pm (ET).

New Jersey Motorsports Park

On over 700 acres, conveniently located to Philadelphia, New York and Washington DC, New Jersey Motorsports Park (www.njmotorsportspark.com) offers an incredible amount of diverse and dynamic motorsports attractions. Included in just the first phase of this tremendous facility are: 2 world class road courses (Thunderbolt and Lightning); an exclusive motorsports country club known as the Drivers Club; unique trackside Villa homes, and a first class karting facility where anyone can experience the thrill of motorsports behind the wheel for the first time.

The principals of this unique motorsports destination include:

Lee Brahin

A classic car racer, Brahin is the operating principal of Brahin Properties, Inc. and affiliated companies, specializing in the development, management, acquisition, financing and brokerage of commercial properties. The current Brahin organization portfolio exceeds 2.5 million square feet and has a value in excess of \$100,000,000 with properties in six states.

Harvey Siegel

A seasoned race car driver and real estate developer, Siegel is the owner of the Virginia International Raceway (VIR). Through his renovations of the historic VIR complex, it has come to be considered one of the nation's premier road courses.

RJ Valentine

A professional race car driver currently competing in the Rolex Grand Am Series, Valentine is a successful entrepreneur, responsible for more than 30 years of business growth in diverse industries. Currently his holding company, MBA Group, controls more than 18 businesses in the insurance, financial services, oil and gas production, investigative services, private jet charter and real estate.

Joe Savaro

Joe Savaro has played a key role in the development and approval process of NJMP, and was the individual who introduced the site to the partnership group. He is also the Director of Asset Management for Brahin Management Corporation, and has over 25 years experience in marketing and managing real estate investments.

SITE



The Drivers Club is an exclusive motorsports country club, with all the amenities you'd expect from a world class facility.



One of New Jersey Motorsports Park most unique and differentiating features are the trackside townhomes know as the Villas at Brighton

F1 Karting provides virtually everyone the opportunity to participate and experience the thrill of motorsports firsthand.



THUNDERBOLT RACEWAY

LIGHTNING ROAD COURSE

KARTING TRACK

POOL

TENNIS

CLUB HOUSE

COMMERCIAL CORNER
- HOTELS
- RESTAURANTS
- RETAIL

PARTICIPANT
REGISTRATION

VILLAS AT
BRIGHTON

VILLAS AT BRIGHTON
MANAGEMENT AND
HOSPITALITY BUILDING

DIVIDING CREEK-MILLVILLE ROAD

BUCKSHUTEM ROAD

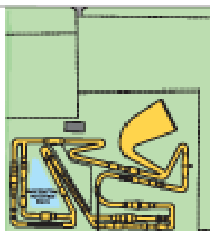

ATV COURSE

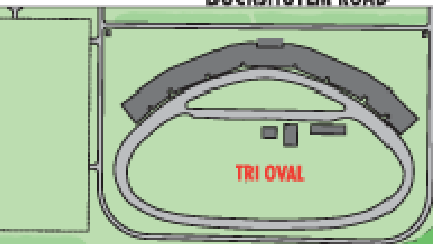

TRI OVAL

TURFGRASS PARKING

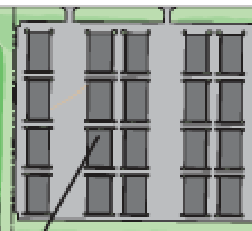

SPEEDPLEX/BUSINESSES,
RESEARCH & DEVELOPMENT

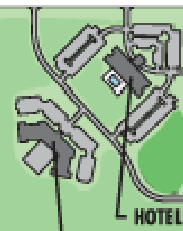

HOTEL

CONFERENCE
CENTER/SPA

Thunderbolt Raceway

The Southern Road Circuit at New Jersey Motorsports Park will be our signature Thunderbolt Raceway featuring over 2.25 miles of asphalt, 14 challenging turns, a one half mile straightway and approximately 40 acres of full service paddock space. Amenities on this circuit will include concession buildings, event garages, twenty (20) VIP Suites, banquet rooms, a covered false grid, and a three (3) story timing tower with media center and VIP facilities.

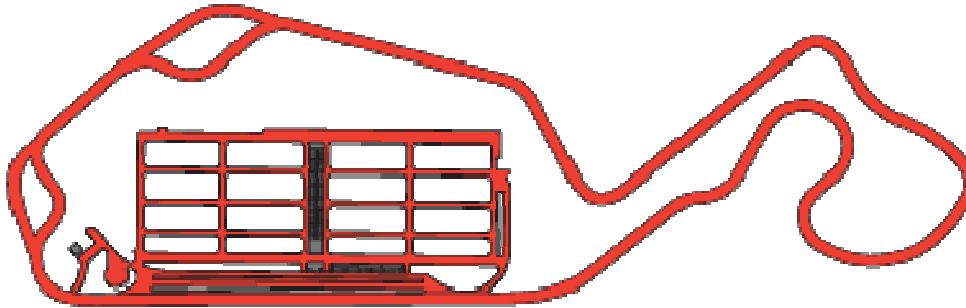

Directions to NJMP

New Jersey Motorsports Park is conveniently located within easy driving distance from New York, Philadelphia, and Washington DC. NJMP is situated at the intersections of Dividing Creek and Buckshutem Roads (Route 555) in Millville NJ, adjacent to the Millville Airport. For detailed directions, including routes for team transporters, go to:

<http://www.njmotorsportspark.com/pdf/DirectionsNJMP.pdf>

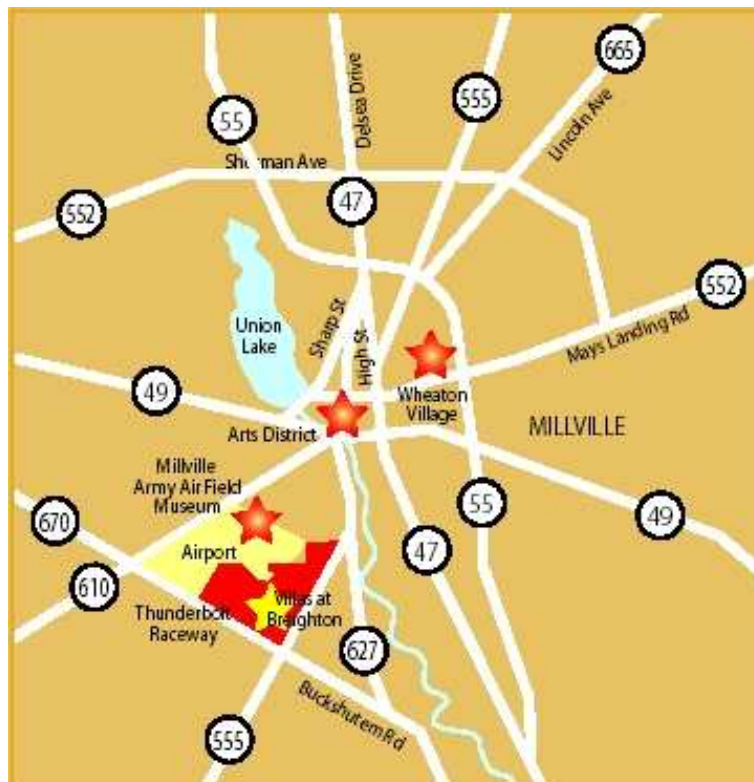

Proposed lodging at the New Jersey Motorsports Park will include approximately 500 hotel rooms, ranging in price range and services, and 3 restaurants all designed to be family friendly. More information and detailed photos will be available as construction nears completion.

VIP SUITES ARE NOW AVAILABLE AT NJMP

VIP Suites provide the ultimate in luxury and convenience. Stay trackside and see all the action from the best vantage point on Thunderbolt Raceway. Please [click here](#) for more information and availability.

In addition, we also offer the following suggestions for nearby lodging and attractions:

Lodging:

1. Wingate Inn

2196 W. Landis Avenue
Vineland, NJ 08360
Phone: (856) 690-9900
Fax: (856) 690-5755

2. Ramada Inn Vineland

2216 W. Landis Avenue
Vineland, NJ 08360
Phone: (856) 696-3800
Fax: (856) 696-2371

3. Days Inn

1001 W. Landis Avenue
Vineland, NJ 08360
Phone: (856) 696-5000
Fax: 856-692-6006

4. Comfort Inn

29 W. Landis Avenue
Vineland, NJ 08360
Phone: (856) 692-8070
Fax: (856) 692-7705

5. Holiday Inn Express and Suites

398 Smith Street
Vineland, NJ 08360
Phone: (856) 293-8888
Fax: (856) 293-1183

6. Quality Inn & Suites

1701 North Second Street
Millville, NJ 08332
Phone: (856) 327-3300
Fax: (856) 327-8092

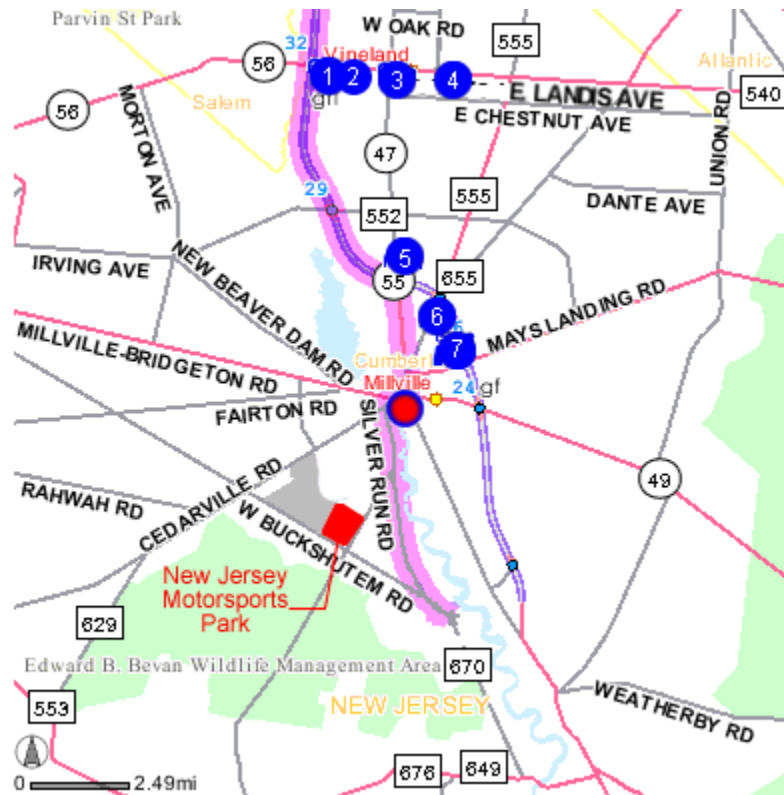

7. Country Inn by Carlson

1125 Village Drive
Millville, NJ 08332
Phone: (856) 825-3100
Fax: (856) 825-1317

Also Nearby:

Hampton Inn Mount Laurel
5000 Crawford Place
Mount Laurel, NJ 08054
856-777-5535
856-778-0377 fax

Fairfield Inn & Suites
340 Century Parkway
Mount Laurel, NJ 08054
856-642-0600
856-642-1311 fax

Wingate by Wyndham
1000 Laurel Oak Road
Voorhees, NJ 08043
Phone: 856-627-1000

Crowne Plaza
2349 West Marlton Pike
Cherry Hill, New Jersey 08002
Phone: (856) 665-6666
Fax: (856) 662-1414

Trocki Hotels
6821 Black Horse Pike
Atlantic City West, EHT, NJ 08234
Phone: (609) 272-0200 Toll Free: 1-800-782-9237 Fax: (609) 646-3703

Holiday Inn Select
One Pureland Drive
Pureland Industrial Park I-295
Swedesboro, NJ 08085
Phone: (856) 467-3322
Fax: (856) 467-3031

Hampton Inn
2 Pureland Drive
Swedesboro, NJ 08085
Phone: (856) 467-6200
Fax: (856) 467-6220

What to Do While in Millville:

In conjunction with the South Jersey Transportation Authority, New Jersey Motorsports Park and Cumberland County are coordinating a network of tourist attractions throughout Cumberland, Salem and the other Bay Shore communities. These attractions will be serviced by shuttle lines that will make it convenient for racers, their families, associates and other spectators to visit and enjoy the hidden treasures of South Jersey.

Nearby NJMP Attractions:

GLASSTOWN ARTS DISTRICT, Downtown Millville, New Jersey

We invite you to enjoy and experience a southern New Jersey town steeped in the history of American glass making while strolling through its downtown Arts District. You'll find 19th century buildings and homes of rich architectural history. There is a focus on fine arts at the Riverfront Renaissance Center for the Arts, a public gallery and education center. Private galleries dot the streetscape with an offering of original paintings, ceramics, glazes, mosaics, and more. Browse among speciality shops -- unique gifts, antiques, books, hand-crafted fashions, candy -- and indulge yourself with old fashioned personal service. You will find an excellent selection of restaurants, cafes and pubs for breakfast, lunch and dinner! The fare includes classic Americana diner-style food, Euro-California cuisine, great subs and pizza, pub fare, Sushi and Chinese, and fine dining in luxurious atmosphere. You'll want to enjoy the wild and scenic Maurice River as you walk along the river walk or enjoy a picnic in the Captain Buck Riverfront Park. There is convenient parking located in the one block that separates the downtown and the river.

[Website](#)

Wheaton Arts and Cultural Center

Located at Wade Boulevard and Village Drive in Millville. Only five miles from the New Jersey Motorsports Park.

WheatonArts is a national cultural treasure. Located on 65 wooded acres, WheatonArts is home to the Museum of American Glass, the Creative Glass Center of America International Fellowship Program, the largest folklife center in the Garden State, a hot glass studio, several traditional craft studios, five museum stores, a 13,000 sq. ft. event center and a beautiful pond-side picnic grove in a true Pineland Sanctuary! In addition to daily glass blowing and craft demonstrations, WheatonArts features special exhibitions, programs, workshops, performances and several weekend festivals throughout the year. WheatonArts offers an extraordinary level of personal interaction with professional artists in a warm and inviting environment.

Hours: April through December: Open Tuesday through Sunday, 10 a.m. to 5 p.m. January, February and March: Open Friday, Saturday and Sunday, 10 a.m. to 5 p.m. Open Memorial Day, July 4 and Labor Day. Closed Easter Sunday, Thanksgiving Day, Christmas Day and New Year's Day.

Admission: April through December: Adults \$10, Senior Adults \$9 and Students \$7. Children five and under are free. January through March: Reduced admission prices offered. Free to shop and stroll except during outside special events.

Museum of American Glass

Museum of American Glass is at Wheaton Village. More than 6,500 objects span the history of American glass from the early 1700s to contemporary works. Exhibits include one of the largest bottles in the world as well as pieces by the Durand, Sandwich, and Tiffany glass companies, and by glass artists Dale Chihuly and Paul Stankard.

Admission: Museum free with Wheaton Village admission

Hours: Tues.-Sun. 10-5, Apr.-Dec.; Fri.-Sun. 10-5, rest of year. Closed Jan. 1, Easter, Thanksgiving and Dec. 25. Guided 45-minute tours depart at 2:30

Millville Army Air Field Museum

Millville Army Air Field Museum is at 1 Leddon St. at the Millville Municipal Airport. Dedicated by the U.S. War Department in 1941, the Millville Army Air Field was known as “America’s First Defense Airport.” Some 100,000 men and women served in Millville during World War II, including 1,500 fighter pilots. Exhibits include aviation artifacts and displays dedicated to the Tusgee airmen, USO women and veterans of World Wars I and II, Korea and Vietnam.

Admission: Donations

Hours: Mon.-Fri. 10-2, Sat.-Sun. 10-4

Vineland Historical and Antiquarian Society

The Society has material relating to Vineland and its surroundings, including items belonging to town founder Charles K. Landis and his family. The museum features locally crafted glassware, military memorabilia, a music room, old firefighting equipment, American Indian relics, and period furniture and clothing. Archives are available for genealogical research. 108 S 7th St, Vineland NJ 08360, Phone 609-691-1111

Also Nearby:

Atlantic City Convention and Visitors Authority

2314 Pacific Avenue

Atlantic City, New Jersey 08401

(609) 449-7145

Ocean City, NJ

“America’s Greatest Family Resort” is one of the country’s finest year-round resort cities, with eight miles of beautiful beaches and bay, 2.5 miles of boardwalk, fine dining establishments and a downtown shopping district with many unique specialty shops. Ocean City, NJ offers a wide variety of the most luxurious and comfortable Lodging establishments. In Ocean City you will

have your choice of B&B's, Hotels and Motels. Many are situated near the boardwalk and beach with all properties offering tons of amenities. Whether coming for just a few nights or a week, the Lodging establishments in Ocean City await you and your family. Visit www.oceancityvacation.com for all your needs.

Contacts at NJMP

For tickets to our upcoming spectator events, please call:
Toll Free 866-550-NJMP or 866-550-6567

For inquiries regarding Drivers Club Membership, please call
Toll Free 866-550-NJMP or 866-550-6567
or via email at membership@njmp.com

For information on scheduling one of our road racing tracks for your club or organization, please contact Joe Volpe at 856-327-8000 or at jvolpe@njmp.com.

For information on scheduling an event at our karting track, please contact Tim Hannen at 856-327-8000 or at thannen@njmp.com.

For inquiries regarding the Villas at Brighton, please contact Joe Esposito directly at 609-221-0206 or at jesposito@njmp.com

For inquires regarding Business Development and Partnerships, please contact Rob Armbruster directly at 856-327-8000 or at rarmbruster@njmp.com.

For inquiries regarding Real Estate Development Opportunities, including restaurants, retail, hotels and industrial, please contact Joe Savaro directly at 215-563-7222 x19 or at jsavaro@njmp.com.

Please direct all general correspondence to the NJMP Millville office:
47 Warbird Drive
Millville, NJ 08332
TEL: (856) 327-8000
FAX: (856) 327-8835
info@njmp.com

